

Maple Fields



Maple Fields is one of Jackson's newest neighborhoods! Maple Fields is currently featuring 5 homesites in a secluded cul-de-sac.

Jackson is one of the fastest growing villages in Washington County and boasts reputable schools.

The wide variety of outdoor activities makes Jackson an adventurous and welcoming community. Ranging from scenic parks, nature preserves, and lakes, Jackson has it all! Hickory Lane Park is a short 1 ½ miles from Maple fields. Enjoy their aquatic play space that gives you a beachy feel without all the sand! This is just one of the many outdoor adventures in this community.

Bring your builder and start you dream home today in Maple Fields in Jackson. You can view the Maple Fields plat and price list on the following pages.

- Homesites: 5 Available
- Min. Size: 1,800 Sq. Ft. Ranch
- Min. Size: 2,100 Sq. Ft. Two-Story
- Lot Size: Approx. 1/2 acre
- Municipal Sewer & Water
- Germantown School District
 - Rockfield Elementary School
 - Kennedy Middle School
 - Germantown High School
- Protective Covenants

DIRECTIONS:

Located on the south side of Jackson with convenient access to I-45. Just south of Sherman Road and west of Maple Road.

CONTACT US TODAY MORE INFORMATION.
262-542-9200 • NEUMANNDEVELOPMENTS.COM



Developing Relationships Building Communities

Maple Fields

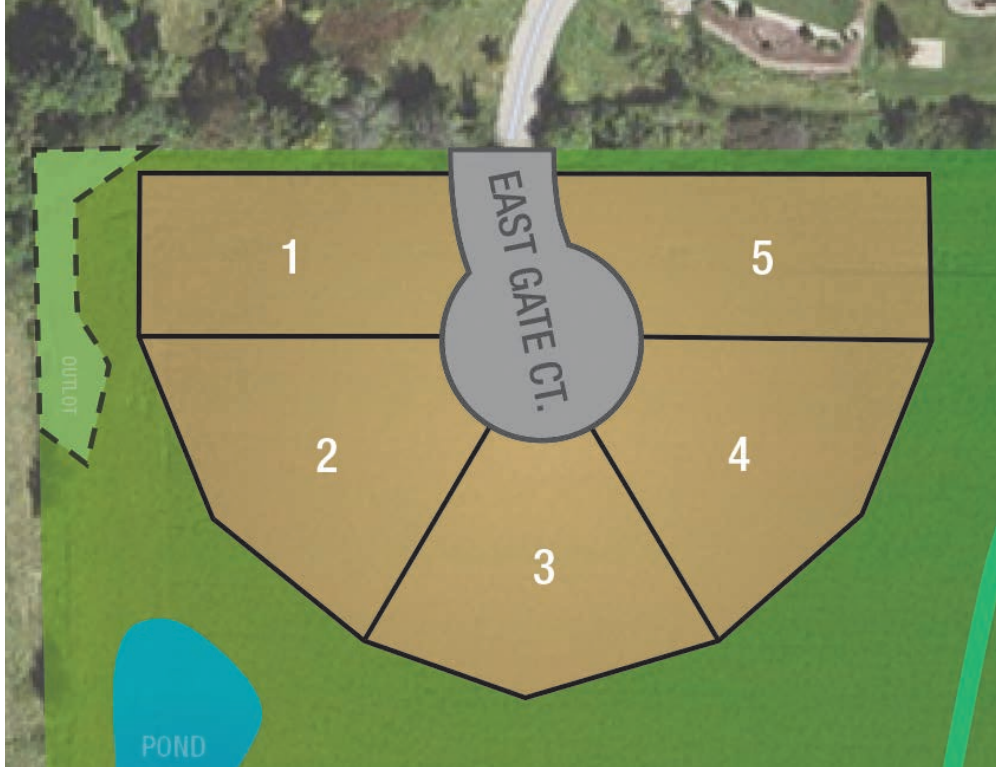

Rendering is deemed to be accurate and is subject to change without notice. Please refer to recorded documents for more details.

Maple Fields

The Estates

Lot	Sq. Ft.	Exposure	Price	Availability
1	19,003	Full	\$122,900	Available
2	23,640	Full	\$127,900	Available
3	20,963	Full	\$129,900	Available
4	22,811	Full	\$129,900	A/O
5	20,185	Full	\$117,900	Sold

Select Any Builder

Information is deemed to be accurate and is subject to change without notice.

Buyers are encouraged to review the recorded plat map and grading plans with their builder.

A/O means "Accepted Offer"